



Rack-Mammut® Bollard Strong 600 mm

Technical data sheet



The Bollard Strong is ideal for marking and securing danger zones indoors and outdoors and is always used when there is a high volume of traffic. Due to its special design, with movable outer rings above the fixed, almost indestructible plastic tube, this bollard can not only absorb impact energy but also dissipate it particularly well. The impact protection Bollard Strong can be used in many ways, e.g. in front of doors, roller shutters, switchboards, walls, driveways, corners and places where machines or similar need to be protected. Its warning signal colour encourages drivers to remain alert.



For high traffic

PRODUCT SPECIFICATIONS

Product features	High-performance, durable special plastic absorbs any impact energy and returns to its original shape. It offers extremely low maintenance and repair cost savings on barriers, racking systems, and industrial trucks.	
Material	Polyolefin, UV-resistant, fire class HB, non-conductive, impermeable to most chemical products.	
Colour	Yellow / Black	
Base plate	Steel black lacquered	INOX (RVS 304) No lacquer/coating

IMPACT TEST PARAMETERS & VALUES PER PAS 13:2017, Sec. 7.5

Test conditions	Impact height:	450 mm
	Pendulum Mass (kg):	572,4 kg
	Pendulum Arm Length (m):	1,65 m
	Pendulum Angel (Radius°):	32,4°
	Pendulum Speed (m/s):	2,24 m/s
	Kinetic Energy	
	90° impact (Joule):	1.370 J
	Deflection (mm):	50 mm

DIMENSIONS

Length/Height	600 mm
Ø	Ø 200 mm
Base plate (WxLxH)	210 mm x 210 mm x 10 mm

SPEED / KG SAMPLE CALCULATION

Reference speed	5,0 km/h	For a vehicle with a gross weight of 1.420 kg with an impact angle of 90°.
Calculation	$\frac{1}{2} \text{ Mass (kg)} \times \text{Speed}^2 \text{ (m/s)} = \text{Joules}$ (Formula applies for an impact angle of 90°)	

FIXING

Heavy-duty concrete anchor	L = 110 mm ; Ø = 12 mm ; M12 45 Nm max. tightening torque 19,7 kN min. pull-out force
----------------------------	---





Rack-Mammut® Bollard Strong 600 mm

Technical data sheet

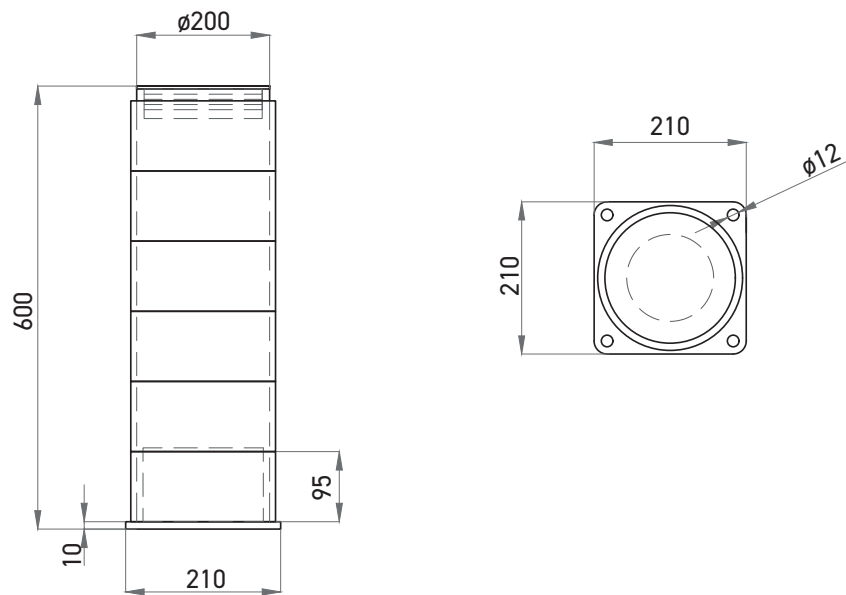

Watch the test
video here!