



Rack-Mammut® Rack End Single Rail Barrier 1200 mm

Technical data sheet



The Rack End Single Rail Barrier is the ideal solution for frontal rows of shelving. It protects the fragile racking structure from impacts from manually operated floor vehicles and motorised forklift traffic. Impacts are absorbed and the single rail barrier returns to its original shape.



For high traffic

PRODUCT SPECIFICATIONS

Product features	High-performance, durable special plastic absorbs any impact energy and returns to its original shape. It offers extremely low maintenance and repair cost savings on barriers, racking systems, and industrial trucks.	
Material	Polyolefin, UV-resistant, fire class HB, non-conductive, impermeable to most chemical products.	
Colour	Yellow / Black	
Base plate	Steel black lacquered	INOX (RVS 304) No lacquer/coating

IMPACT TEST PARAMETERS & VALUES PER PAS 13:2017, Sec. 7.5

Test conditions	Impact height:	258 mm
	Pendulum Mass (kg):	674,8 kg
	Pendulum Arm Length (m):	1,65 m
	Pendulum Angel (Radius°):	65°
	Pendulum Speed (m/s):	4,32 m/s
	Kinetic Energy	
	90° impact (Joule):	5.991 J
	45° impact (Joule):	11.982 J
	Deflection (mm):	70 mm

DIMENSIONS

Length/Height	1200 mm / 400 mm
Ø	Ø 180 mm base / Ø 144 mm connecting tube
Base plate (WxLxH)	210 mm x 210 mm x 10 mm

SPEED / KG SAMPLE CALCULATION

Reference speed	7,5 km/h	For a vehicle with a gross weight of 5.500 kg with an impact angle of 45°
Calculation	$\frac{1}{2} \text{ Mass (kg)} \times \text{Speed}^2 \text{ (m/s)} = \text{Joules}$ (Formula applies for an impact angle of 45°)	

FIXING

Heavy-duty concrete anchor	L = 110 mm ; Ø = 12 mm ; M12 45 Nm max. tightening torque 19,7 kN min. pull-out force
----------------------------	---





Rack-Mammut® Rack End Single Rail Barrier 1200 mm

Technical data sheet

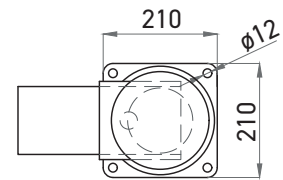
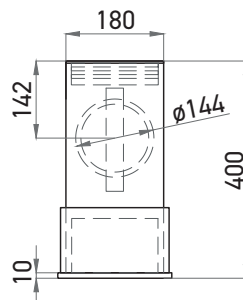
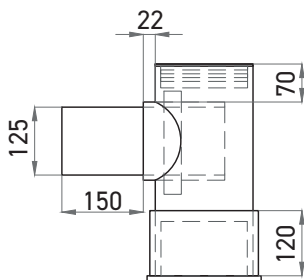
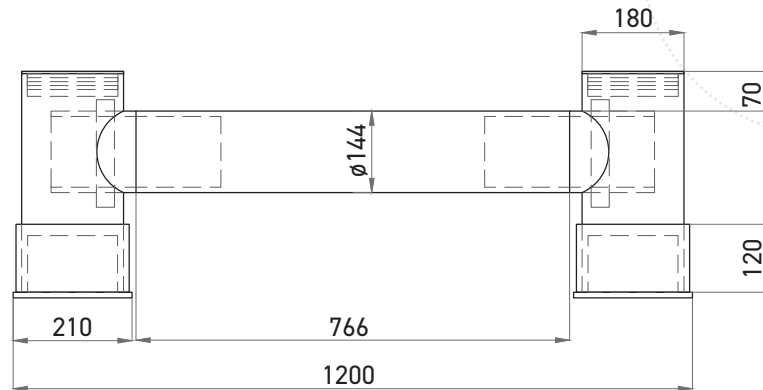

Watch the test
video here!