



USER GUIDE

Thank you for purchasing the JumpsPower™. Before operating your new device, please read this user's manual carefully.

Product Layout:

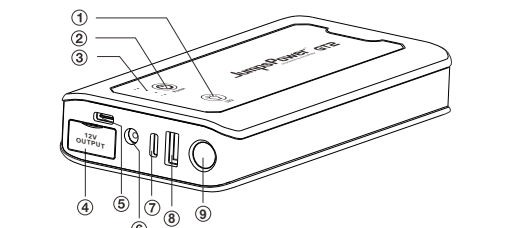

Table with 2 columns: Numbered callout (1-9) and Component Name (LED On/Off Button, Power Button, Battery Indicator Light, 12V Jump Start Output, USB-C Input, DC Output, USB-C Output, USB-A Output, LED Light, USB-C Input).

Parts List:

Table with 4 columns: #, Parts Name, Qty, #, Parts Name, Qty. Lists JumpsPower-GT2, USB-A to USB-C Cable, Cigarette Lighter Adapter, Jumper Cable, User Manual, Carry Bag.

Specifications:

Battery Capacity: 37000mAh / 37Wh / 10000mAh. Battery Type: Lithium-Ion. Peak Amps: 12V == 20000A\*. Clamp Power: 12V == 1000A. USB-C Input: 18W Max (5V==3A, 9V==2A, 12V==1.5A).

Battery Indicator Lights:

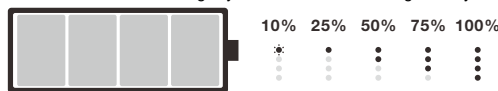

Charge the JumpsPower™:

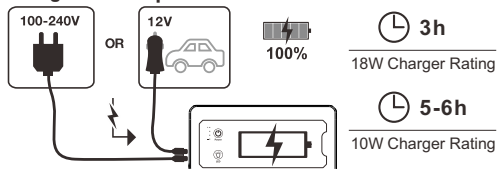

Remarks: USB Wall Charger and Car Charger is NOT included. Only use quality USB charger to perform the input charging.

How To Jump Start a Vehicle:

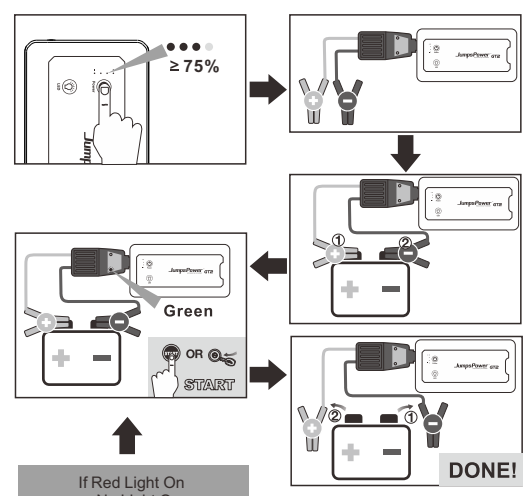
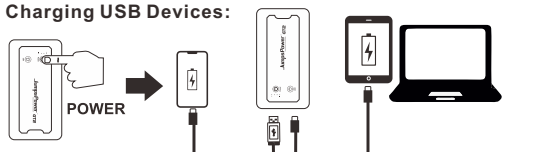
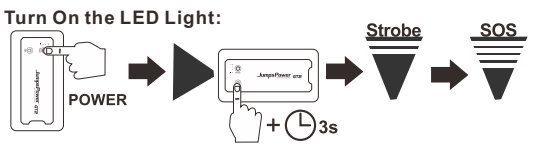
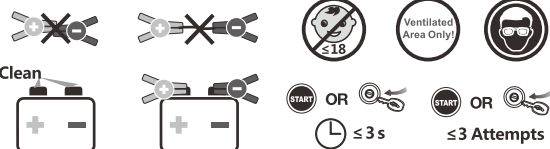

Table with 3 columns: Error Status, Light & Beep, Action. Lists Reverse Polarity, Low Battery, Overtime, Reverse Charge / Over Voltage, Overheat.

No Green Light On: Please make sure correct connection. Boost Mode - Max. 10 seconds; Standard Mode - Max. 50 seconds.

Jump Starting Warnings!



Remarks: If you want to perform fast output charging, please purchase a USB-C to USB-C charging cable yourself.

Using 12V DC Output Port:

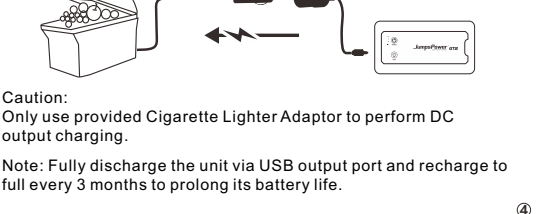

Turn Off the JumpsPower™:

When detect no LOAD for 30 seconds, the unit will turn off by itself. Make sure Jumper cable is NOT connected to the unit when storage.

Toxic and Harmful Substances:

Table with 7 columns: Pb, Hg, Cd, Cr(VI), PBB, PBDE, O. All cells are empty.

Instructions Pertaining to Risk of Fire, Electric Shock, or Injury to Persons.

- Warning: Always wear safety glasses when jump starting a battery. Do not immerse the product in water. Do not operate the product in explosive atmospheres.

Important Safety Instructions:

WARNING - When using this product, basic precautions should always be followed, including the following:

- a) Read all the instructions before using the product. b) To reduce the risk of injury, close supervision is necessary when the product is used near children.

- NEVER smoke or allow a spark or flame within the vicinity of battery or engine. Be extra cautious to reduce risk of dropping a metal tool onto battery.

Warranty Information:

We offer a limited warranty for this product against any defects in material and workmanship for a period of 1 year from the date of purchase by the end user/consumer.

- 1) The warranty is only valid upon presentation of the original receipt. 2) The warranty is void if the serial number, date of purchase and label are removed.



JumpsPower is a trademark of AmosMotor™. All rights reserved. V202405



使用需知

歡迎使用JumpsPower™多功能移動電源，使用產品前請先詳細閱讀此使用需知以了解產品規格、正確操作模式、安全指引及其他相關有用資訊。

產品外型:

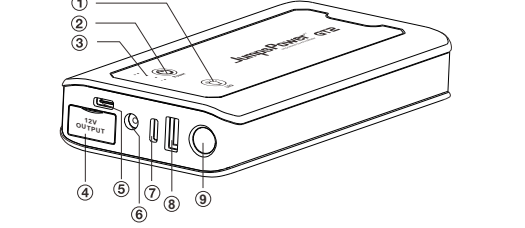

Table with 2 columns: Numbered callout (1-9) and Component Name (LED指開關, 開關, 電量指示燈, 12V汽車起動端口, USB-C輸入口, DC輸出, USB-C輸出, USB-A輸出, LED燈, USB-C輸入口).

產品配件:

Table with 4 columns: #, 品名, 數量, #, 品名, 數量. Lists JumpsPower-GT2, USB-A轉USB-C充電線, 12V點煙器轉接線, 智能防火花電瓶夾, 說明書, 保護布袋.

產品規格:

電池容量: 37000mAh / 37Wh / 10000mAh. 電池種類: 鋰電池. 轉值安培: 12V == 20000A\*. 起動電流: 12V == 1000A.

電量指示燈:

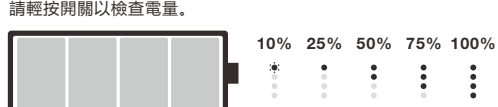

向JumpsPower™充電:

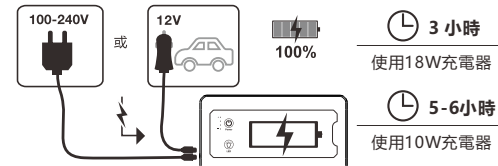

備註: 產品包裝內不含家用USB充電器和汽車USB充電器。請用質量合格的PD USB充電器進行快速輸入充電。

如何起動汽車引擎:

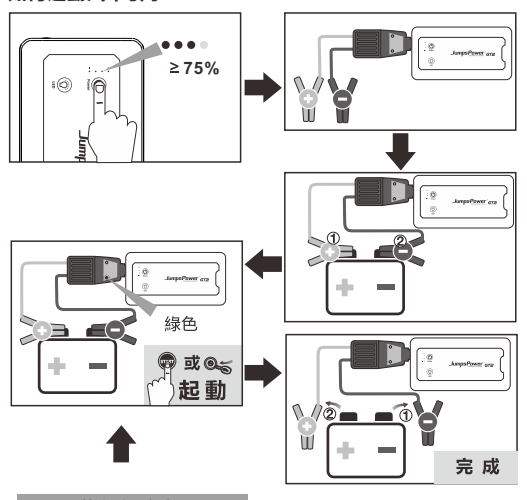
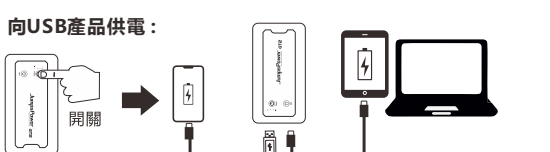
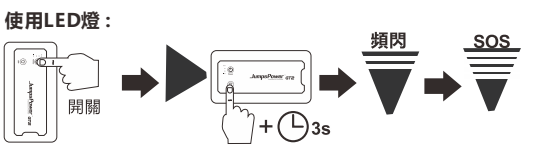
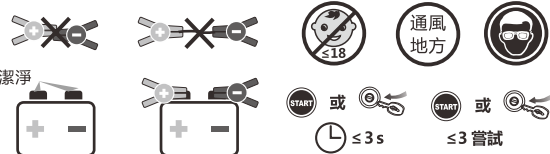

Table with 3 columns: 錯誤狀態, 閃燈及蜂鳴, 行動. Lists 反接, 低電量, 過熱, 反充或過壓, 過熱.

- 如有沒有亮燈, 請先檢查確保連接正確, 然後按BOOST鍵3秒, 直到綠燈亮起, 才可以進行起動引擎。

汽車起動警告!



警告: 若想進行快速輸出充電, 請自行購買 USB-A 到 USB-C 充電線。

使用12V DC輸出口:

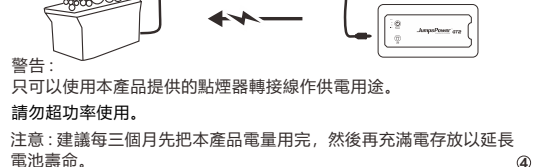

關於JumpsPower™:

JumpsPower™具有自動關機功能, 當沒有接上相關電子產品, 等待30秒, 主機會進入睡眠模式。

Table with 5 columns: 鉛(Pb), 汞(Hg), 鎘(Cd), 六價鉻, 多氯聯苯(多氯聯苯), 多氯聯苯(多氯聯苯). All cells are empty.

有關火災、觸電或使用受傷風險的說明:

- 警告: 在維修場地, 或使用過程中請勿將產品放在地板上或高度不高的地方, 必須放在高於地面457毫米(18英寸)。

重要安全說明:

警告: 使用本產品時, 應注意基本的注意事項及必須遵循以下內容。

- a) 在使用產品之前, 請閱讀所有說明。 b) 為了減少受傷的危險, 該產品在兒童附近使用時必須進行嚴密的監督。

- 切勿在電池或引擎附近吸煙或允許火花火花的產生。要格外小心以減少將金屬工具掉落到電池上的風險。

保固及維修:

提供1年保固服務及維修範圍。

- 1. 如要修理或更換, 需出示購買收據正本。 2. 如商品上的序號及標籤被撕掉, 不予保用。



JumpsPower is a trademark of AmosMotor™. All rights reserved. V202405