

## User Manual

Thank you for purchasing the JumpsPower™. Before operating your new device, please read this user's manual carefully. This manual will inform you of the JumpsPower™'s specifications and proper operation procedures, safety warnings and other useful information. Please keep this manual for easy reference.

### Product Layout:

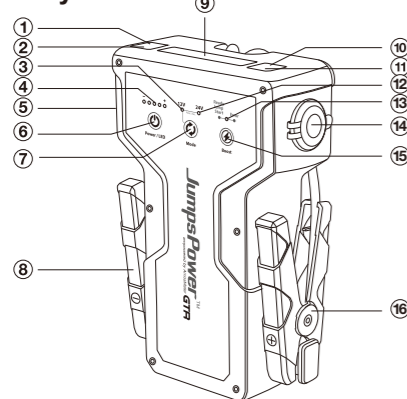

①	USB-C Output	⑨	LED Light
②	DC Input	⑩	USB-A Output 2
③	12V Indicator Light	⑪	USB-A Output 1
④	Battery Indicator Light	⑫	24V Indicator Light
⑤	LED Flashlight	⑬	Jump Start Indicator Light
⑥	Power / LED Button	⑭	DC Output
⑦	Mode Button(12V/24V)	⑮	Boost Button
⑧	Black Clamp	⑯	Red Clamp

### Turn Off the JumpsPower™:

When detect no LOAD for 30 seconds JumpsPower™ will turn off by itself.

### Toxic And Harmful Substances:

Composition and amount of toxic and harmful substances in Jump Starter					
Pb	Hg	Cd	Cr(VI)	PBB	PBDE
○	○	○	○	○	○

○: Indicate all homogeneous materials' hazardous substances content are below the MCV limit specified in the Standard 2002/95/EC(RoHS).

### Instructions Pertaining to Risk of Fire, Electric Shock, or Injury to Persons and Warnings:

- Always wear safety glasses when jump starting a battery (to protect your eyes), and gloves when handling a battery (to protect your hands).
- When jump starting a vehicle please ensure that the blue plug is securely fitted into the jump start socket on the jump starter.
- Ensure the battery clamps are connected correctly, and the connectors are free from rust and dirt.
- Do not allow this product to become wet. Exposure to excessive moisture will damage the unit.
- Do not immerse the product in water.
- Do not operate the product in explosive atmospheres, such as in the presence of flammable liquid, gas or dust.
- Do not modify or disassemble this product.
- Do not store in locations where the temperature may exceed 40°C (104°F).
- Only charge within rated specifications.
- Under extreme heat conditions, battery leakage may occur. Avoid contact with your skin. In case of skin or eye contact, rinse immediately with clean water and seek medical attention.
- If battery leakage occurs, take it to your local battery recycling center for disposal. Do not attempt to use.
- Do not place the jump starter on the floor, or at a height less than 457mm(18 inches ) above the floor, during use in a repair facility.
- This car jump starter is for use with 12V & 24V vehicles. Using on incorrect voltage may cause serious damage to the vehicle, jump starter, or injury to the user. Refer to the owner's manual for the vehicle if you are uncertain what voltage the vehicle runs on.

### Parts List:

#	Parts Name	Qty	#	Parts Name	Qty
1	JumpsPower-GTR	1	4	User Manual	1
2	Jumper Cable	1	5	Carry Case	1
3	AC Adapter	1			

### Specifications:

Battery Capacity : 9990mWh/ 99.9Wh / 27000mAh  
 Battery Type : Lithium-ion  
 Peak Amps : 24V & 12V / 4000A\*  
 Clamp Power : 24V & 12V / 2000A  
 USB-A Output 1 : QC 18W Max.  
 USB-A Output 2 : 10W Max. (5V / 2A)  
 USB-C Output : PD 36W Max.  
 DC Output : 130W Max. (12V-16.8V / 8A)  
 Input 15V / 2A  
 Operating Temperature : -20°C to 60°C  
 Dimensions : 255 x 173 x 75mm  
 Weight : 1.8kg \*Theoretical Short Circuit Current  
 Recommended Vehicle Engine Displacements for Jump Starting :  
 ⚡ For all 12V or 24V vehicles

### Battery Indicator Lights:

Press the Power button lightly to check the remaining battery level.

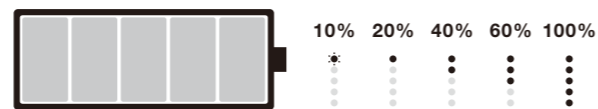

### Charge the JumpsPower™:

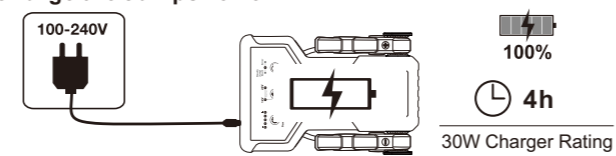

Remarks: Only use original charger to recharge.

Note: Fully discharge the battery via USB output port and recharge to full every 3 months to prolong its battery life.

### Important Safety Instructions:

WARNING - When using this product, basic precautions should always be followed, including the following:

- Read all the instructions before using the product.
- To reduce the risk of injury, close supervision is necessary when the product is used near children. Children should not operate this device unless under strict supervision by a person responsible for their safety.
- Do not put fingers or hands into the product.
- Do not use any attachment that is not sold by jump starter manufacturer which may result in a risk of fire, electric shock, or injury to persons.
- To reduce risk of damage to the electric plug and cord, pull the plug rather than the cord when disconnecting the jump starter.
- Do not use a battery pack or appliance that is damaged or modified. Damaged or modified batteries may exhibit unpredictable behavior resulting in fire, explosion or risk of injury.
- Do not operate the jump starter with a damaged cord or plug, or a damaged output cable.
- Do not disassemble the jump starter; take it to a qualified service person when service or repair is required. Incorrect reassembly may result in a risk of fire or electric shock.
- To reduce the risk of electric shock, unplug the jump starter from the outlet before attempting any instructed servicing.
- Risk of explosive gases.
  - Working in vicinity of a lead acid battery is dangerous. Batteries generate explosive gases during normal battery operation. For this reason, it is of the utmost importance that you follow the instructions each time you use the jump starter.
  - To reduce risk of battery explosion, follow these instructions and those published by battery manufacturer and manufacturer of any equipment you intend to use in vicinity of the battery. Review cautionary marking on these products and on engine.
- Personal precautions.
  - Consider having someone close enough by to come to your aid when you work near a lead-acid battery.
  - Have plenty of fresh water and soap nearby in case battery acid contacts skin, clothing, or eyes.
  - Wear complete eye protection and clothing protection. Avoid touching eyes while working with battery.
  - If battery acid contacts skin or clothing, wash immediately with soap and water. If acid enters eye, immediately flood eye with running cold water for at least 10 minutes and get medical attention immediately.

### How To Jump Start a Vehicle:

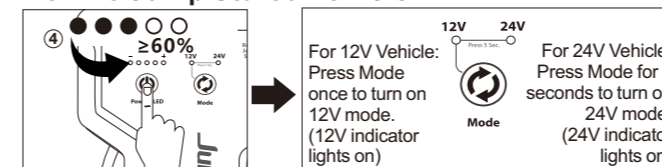

**NEVER** Try to jump start 12V vehicles if it is 24V mode.

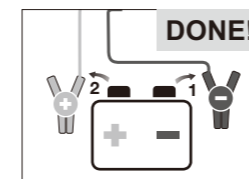

**IF** Red Light On or No Light On

Error Status	Light & Beep	Action
Reverse Polarity	●	Correct the connection
Low Battery	☀	Recharge Jump Starter
Reverse Charge / Over Voltage	☀☀☀	Disconnect Jumper Cable
Overheat	☀☀☀☀	Cool down for 10 minutes

○ No Green Light On: Please make sure correct connection, then press the BOOST button by 3 seconds until Green Light On means ready to start.

\* Allowable time frame for jump start after connected:  
 Boost Mode - Max. 10s ; Standard Mode - Max. 50s.  
 \* Do not crank the engine for more than 3 seconds.  
 \* If jump start fail, disconnect jumper cable and reconnect.

### Save this Instruction:

WARNING: This Jump Starter is intended to jump start 12V & 24V petrol / diesel cars, trucks, boats, or motorcycles with an internal combustion engine and single lead-acid battery systems. Do not use this device to jump start batteries outside of these four types of vehicles; doing so may cause a fire or other serious injuries. Refer to the user manual for additional safety information.

### Jump Starting Warnings!

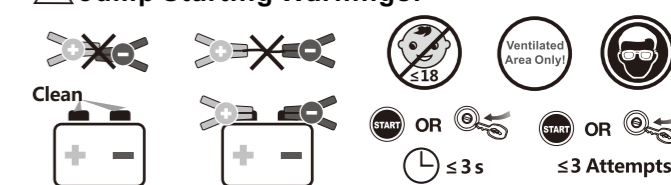

### Turn On the LED Light:

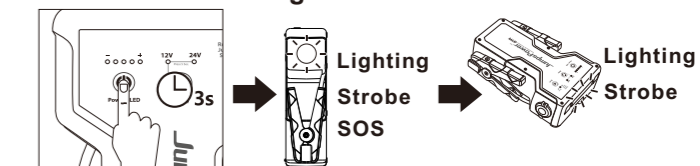

### Charging USB Devices:

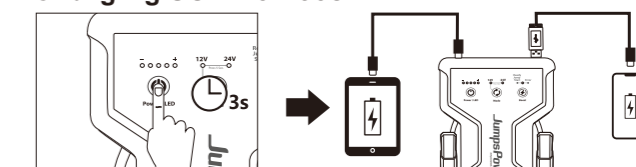

Remarks: Only use qualified USB cable to perform quick charge!

### Using 12V DC Output Port:

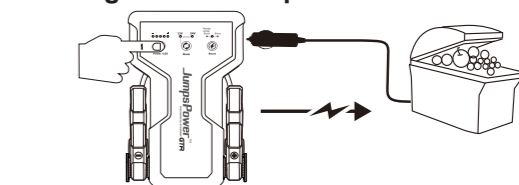

Caution: Do not exceed the rated output power.

### Warranty Information:

We offer a limited warranty for this product against any defects in material and workmanship for a period of 1 year from the date of purchase by the end user/consumer. The conditions of the warranty are as follows:

- The warranty is only valid upon presentation of the original receipt (from dealer/retailer) by the original purchaser with the product to be repaired or replaced.
- The warranty is void if the serial number, date of purchase and label are removed.
- The warranty does not cover damage or product failure resulting from normal wear and tear, physical abuse, improper installation, misuse, modification or repairs by unauthorized third parties.
- We do not assume responsibility for any loss or damage incurred during shipment or as a result of a force majeure.
- We are not liable for any incidental or consequential damages arising from the use or misuse of this product.
- All warranty claims are limited to repair or replacement of the defective product and at the sole discretion of us.
- If we repair or replace the product, the product will be covered for the remaining time of the original warranty period. Repair or replacement may involve the use of reconditioned units which are equivalent in function. Replaced part or product becomes the property of us.
- Consumable components such as batteries are not covered by the warranty.
- Our goods come with guarantees that cannot be excluded under the Australian Consumer Law. You are entitled to a replacement or refund for a major failure and compensation for any other reasonably foreseeable loss or damage. You are also entitled to have the goods repaired or replaced if the goods fail to be of acceptable quality and the failure does not amount to a major failure (Applied to Australia Market Only).

