

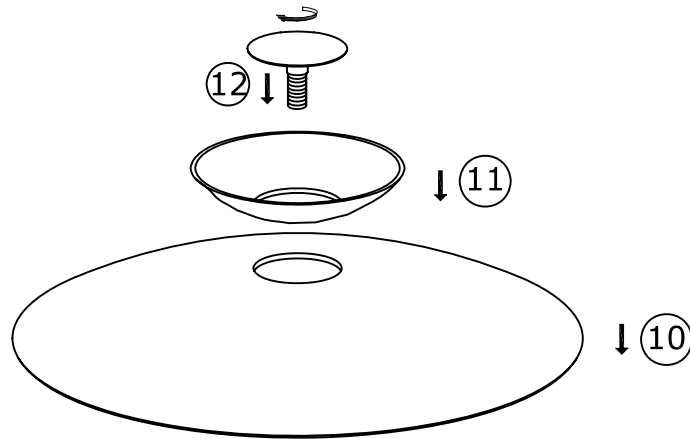



Scandinavia gulvlampe Ø 40







Wattage: MAX 40W
Lamp type: E27
Supply: 230V ~, 50Hz



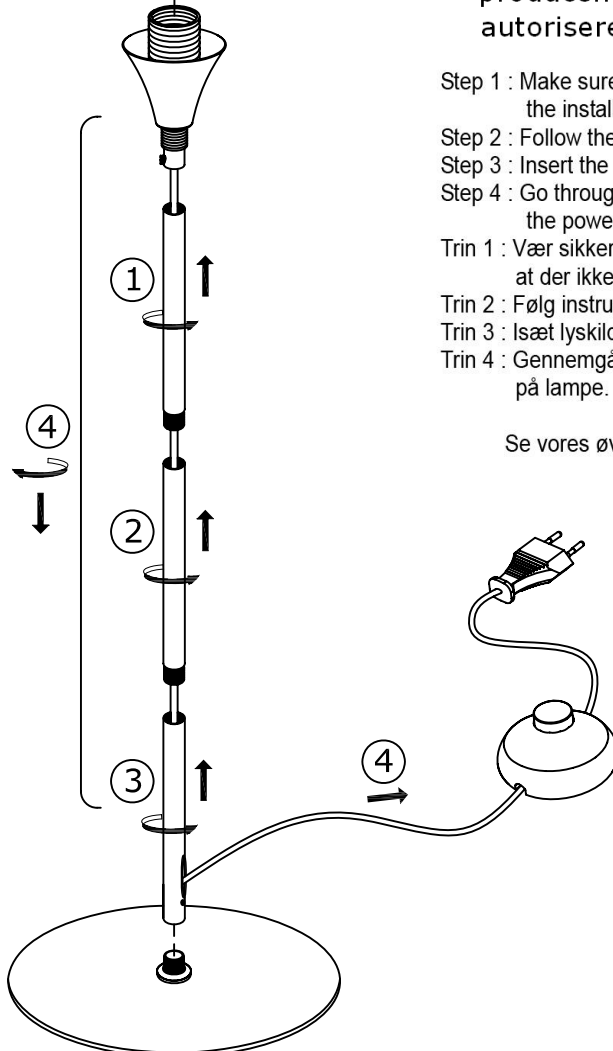
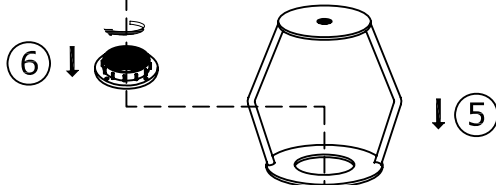
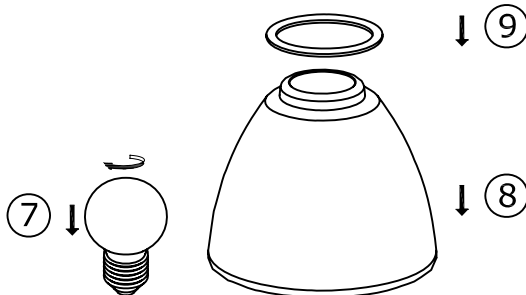

230V.E27.MAX 40W



If the outside cord is damaged or broken, it should be changed/ repaired by the manufacturer or a qualified electrician.

Hvis yderkappen på det strømførende kabel er brudt, skal det udskiftes af producenten eller repareres af en autoriseret elinstallatør.

Step 1 : Make sure power is OFF on the outlet, before beginning the installation

Step 2 : Follow the instruction sketch above

Step 3 : Insert the light bulb

Step 4 : Go through point 1 to 3 before connecting the lamp to the power

Trin 1 : Vær sikker på at kontakten på væggen er slukket, således at der ikke er strøm på lampeudtaget/stikkontakten.

Trin 2 : Følg instruktionstegningen nøje ved samling af lampen.

Trin 3 : Isæt lyskilden

Trin 4 : Gennemgå instruktionstegningen inden der sættes strøm på lampe.

Se vores øvrige sortiment på www.halodesign.dk

**halo
design**

COPENHAGEN