

Cotton Candy Machine

ON-CC1



INSTRUCTION MANUAL

CONTENTS

CONTENTS	1
SAFETY	1
IMPORTANT SAFETY PRECAUTIONS	2
SPECIFICATIONS & FEATURES	3
PACKAGE CONTENT	4
PARTS & ASSEMBLY	5
PREPARATION	6
OPERATING PROCEDURES	6
MAKING FLOSS	7
CLEANING & MAINTENANCE	8
PROBLEMS & SOLUTIONS	9
ELECTRICAL SCHEMATIC	9

SAFETY

Your safety and the safety of others are very important. We have provided many important safety messages in this manual and on your appliance. Always read and obey all safety messages.



This is the safety alert symbol.





This symbol alerts you to potential hazards that can kill or hurt you and others.

All safety messages will follow the safety alert symbol.

All safety messages will tell you what the potential hazard is, tell you how to reduce the chance of injury, and tell you what can happen if the instructions are not followed.

IMPORTANT SAFETY PRECAUTIONS

Your safety and the safety of others are very important. Read all instructions before operating this appliance.

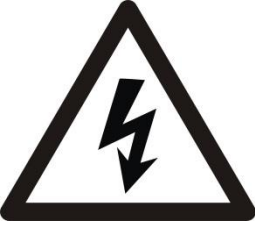
	<p>When using an electrical appliance, basic Safety precautions should always be followed. Only trained personnel should operate this equipment. DO NOT use outdoors.</p>
	<p>Wear proper eye protection when servicing, cleaning or maintaining your machine such as safety glasses.</p>
	<p>To avoid injury, NEVER touch rotating head. All operators MUST keep their body well away when machine is in operation.</p>
	<p>Head surface are hot and should not be touched during turning and heating, or just after use. Do not make any alternations to your machine.</p>
	<p>Unplug from outlet when not in use and before cleaning. Allow to cool before putting on or taking off parts, and before cleaning the appliance. Machine must be properly grounded to prevent electrical shock. To protect against electric shock, do not immerse cord, plugs, or this appliance in water or other liquid.</p>

SPECIFICATIONS & FEATURES

Model	ON-CC1
Machine Size	52X52X46.5CM
Net Weight	10.5KG
Motor Power	80W
Heating Power	1000W
Voltage	220-240V
Frequency	50Hz
Yield	1 cone/20sec

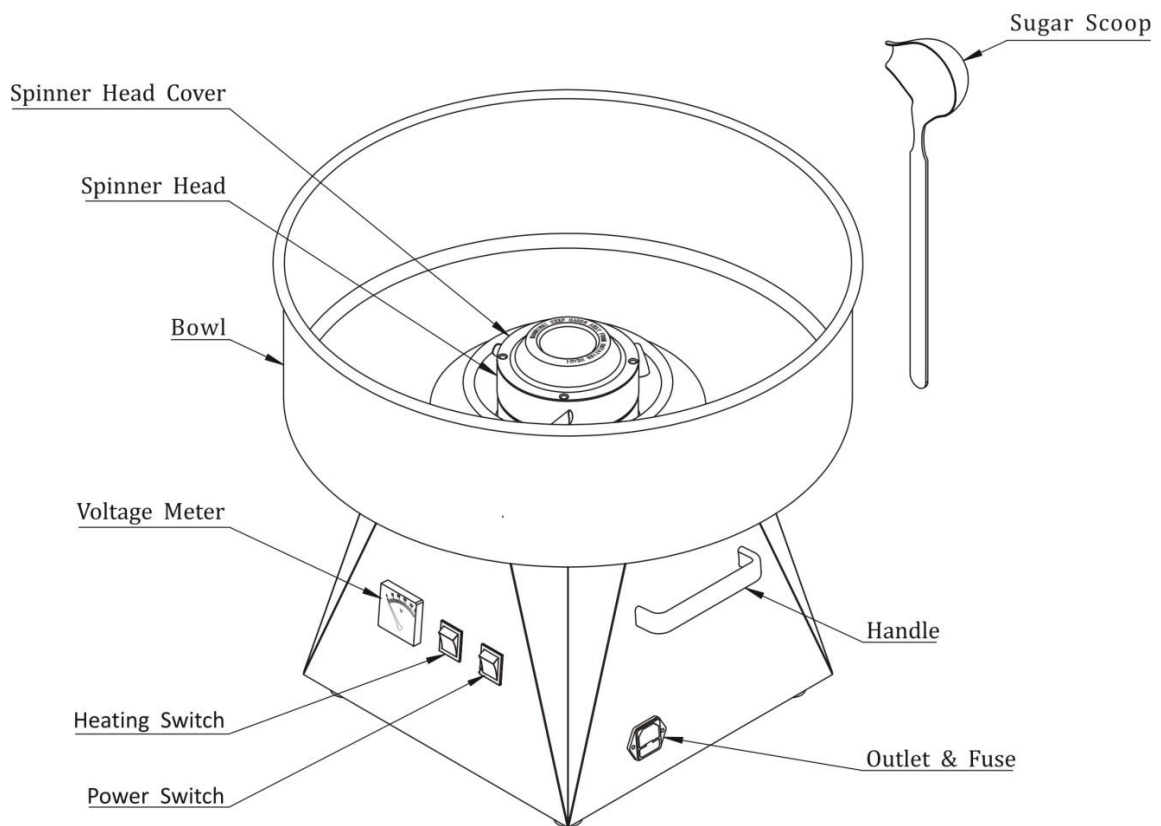

- High capacity spinner head
- warms up quickly
- working very quiet
- automatic heat adjustment
- powder coated sturdy metal construction
- stainless steel bowl
- 1080W of power
- simple use
- Professional Controls
- heavy duty motor
- volt display Meter
- Side handle for easy moving
- Built in fuse for safety use
- Sugar Scoop Included to fill sugar in spinner
- Stainless steel pan, easy to clean with a damp cloth
- 4 rubber feet keep machine stable and avoid machine moving
- 1 Spare Belts, 1 Fuse
- Works continually and yields one cotton candy cone per 30 seconds
- Unit disassembles for easy cleaning and maintain
- CE listed
- one year parts warranty

PACKAGE CONTENT

- 1 x Cotton Candy Machine
- 1 x Bowl
- 1 x Power Cord
- 1 x Sugar Scoop
- 1 x Owner's Manual
- 1 x Fuse

PARTS & ASSEMBLY

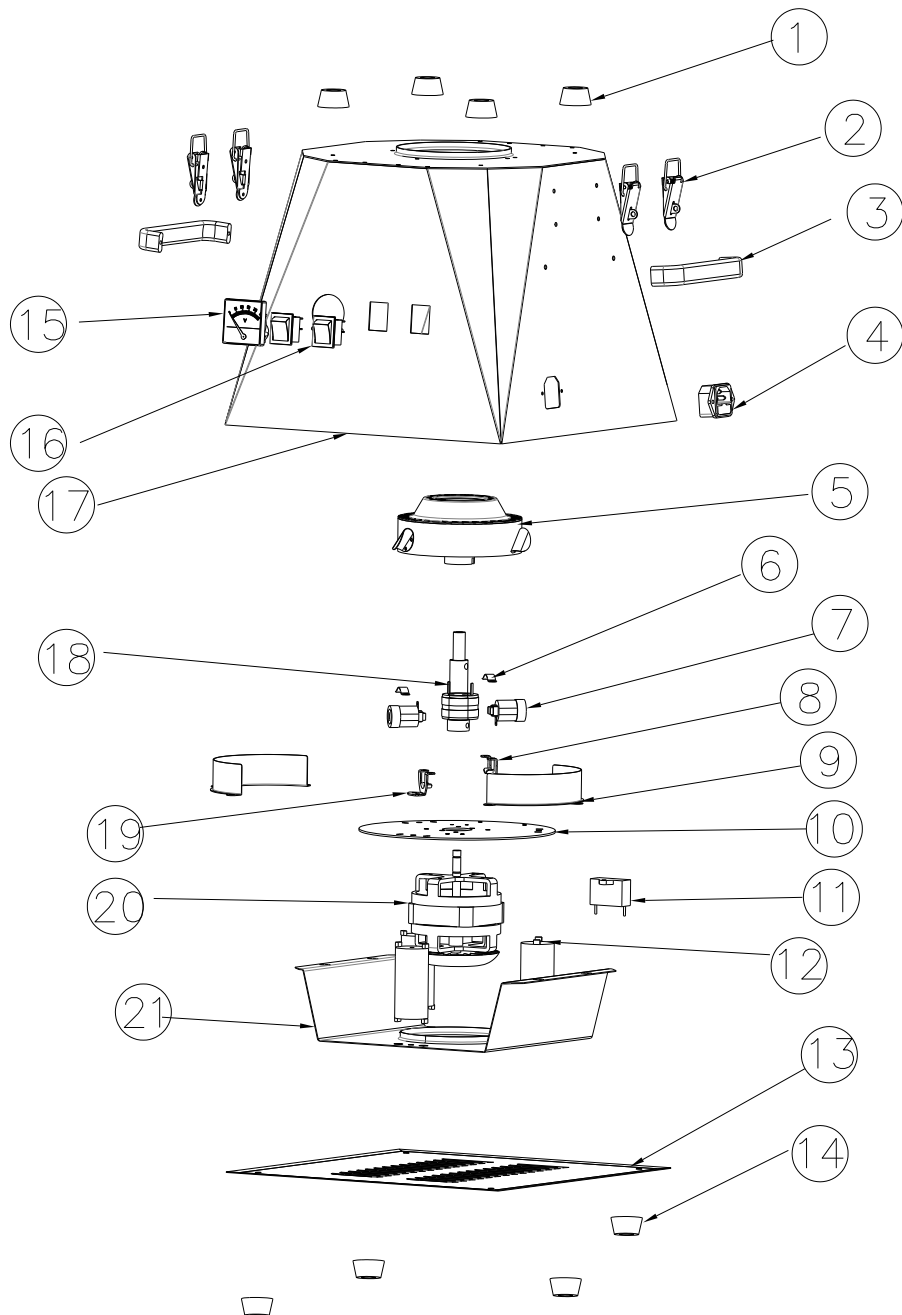

- 1:Rubber feet 2:Hasp Lock 3:Handle 4:Outlet & Fuse
 5:Spinner Head 6:Carbon brush presser 7:Carbon Brush
 8:Long carbon brush holder 9:Protection Shield 10:Motor setting plate
 11:Capacitance 12:Damper 13:Baseplate 14: Rubber feet 15:Voltage Meter
 16:Power Switch 17:Cabinet 18:Conducting ring and Axis
 19:Short carbon brush holder 20:Motor 21:Assembly board

PREPARATION

1. Read all instructions before using your cotton candy machine
2. Make sure the spinner head and bowl are clean
3. This product requires a properly-grounded
240 volt supply with a 10 amp circuit for Europe
120 volt supply with a 15 amp circuit for North America,
4. Keep your work area clean, well-lit and free of clutter or obstruction,
make sure machine on a stable and level surface.

OPERATING PROCEDURES

Note: Never use powder color, It will burn sugar head easy. Please use liquid color, if you need make color candy floss.

1. Place machine on a flat and stable surface.
2. Plug in Cotton Candy Machine, This item will not operate properly on a shared circuit. Make sure machine working normal.
3. Without motor running, fill floss head with sugar. **DO NOT OVERFILL!** Whenever adding sugar to the floss head, always fill it less than 90% full.
4. Press the Power and heat switch to the "ON" position, let it run and warm-up for 2 minutes. 2 minutes later, the machine should begin to make floss.
5. Refill more sugar with scoop, when cotton floss coming out slow.
6. When all the sugar in the spinner head was finished, press the Heat switch to the "OFF" position and wait 3-5 minutes before press Power switch to the "OFF" position. To make sure no sugar was left in the spinner head, when finished making cotton candy, or the spinner head will probably be blocked.

Video: <https://www.youtube.com/watch?v=nStVvhOKMrs>

MAKING FLOSS

1. Grip cone as shown

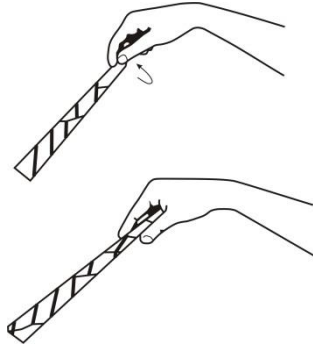

2. Break into web of floss with the cone

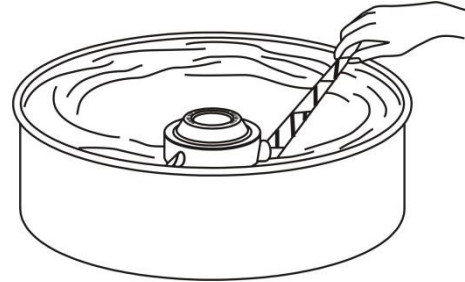

3. Wind the sugar onto the cone

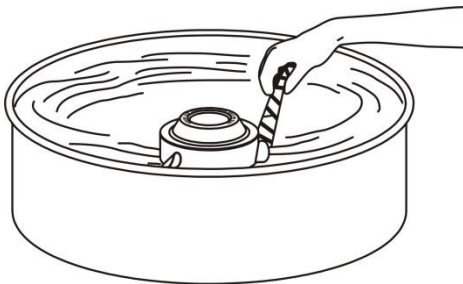

4. Lift web of floss from the pan and roll onto the cone.

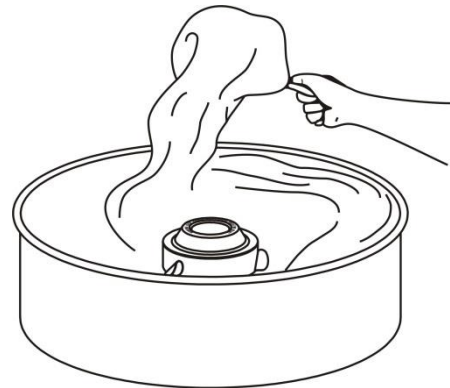

5

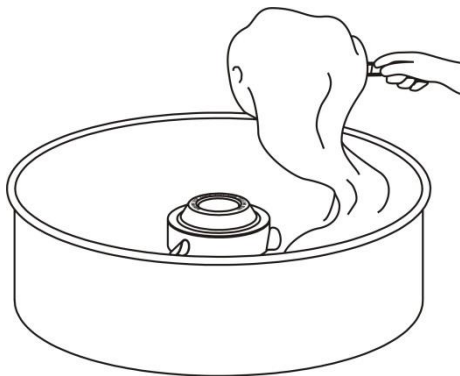

6

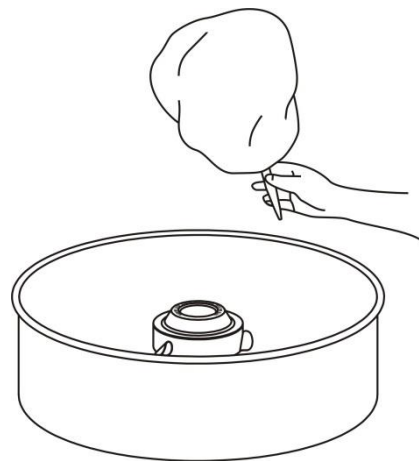

CAUTION

- WEAR eye protection such as safety glasses. Steam will come out, when pour water in the spinner head, wear glasses and be careful
- DO NOT pour water out of the spinner head. Make sure pour water in the hole of the spinner head.

CLEANNING & MAINTENANCE

After make 5 – 6pcs candy floss or a constant use, you need clear the head:

1. Keep spinner head rotating and heating, when all sugar in spinner head was finished, pour some water in the hole of spinner head slowly, several times and let it rotate 2-3 minutes. Water will be jetted out from spinner head into to bowl.
2. Turn Power and heat switch to the "OFF" position, unplug and allow to cool completely, then wipe head and bowl with a clean moistened warm soft cloth.

CAUTION

- DO NOT put hands or objects in rotating spinner head.
- Operator should ALWAYS wear eye protection.
- DO NOT put hands near rotating spinner head.
- Use ONLY floss cone to collect cotton candy.

PROBLEMS & SOLUTIONS

Problems	Solutions
Machine no Power	1、 Check power cord connecting is right or not 2、 Check fuse
Big noise	1. Place machine on a flat and stable surface 2. Check spinner head was blocked or not
Spinner head heating, no floss come out	Clean the spinner head
Spinner head rotating speed slow	Open the machine at bottom to check belt is lose or not
Can't remove screws on spinner cover	Heating up spinner head and remove screws Caution: Be care full high temperature, use a moistened cloth cover spinner head to remove screws
Spinner head not heating up	1. Check wire lose or not 2. Check carbon brush was finished or not 3. Contact a qualified electrician

ELECTRICAL SCHEMATIC

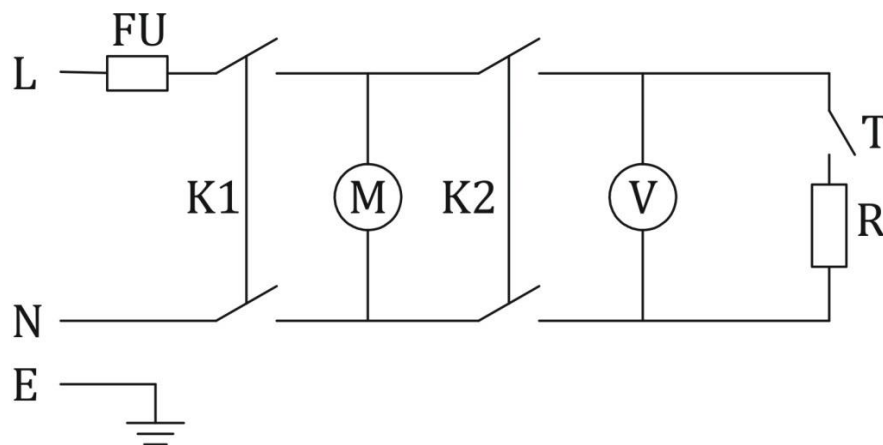

K1---- Power Switch

K2---- Heating Switch

M---- AC Motor

V---- AC Voltage Meter

FU---- Fuse

T---- Thermostat

R---- Heating element